

634-ZZ

Deep groove ball bearing

Single row deep groove ball bearings are particularly versatile, have low friction and are optimized for low noise and low vibration, which enables high rotational speeds. They accommodate radial and axial loads in both directions, are easy to mount, and require less maintenance than many other bearing types.

- Simple, versatile and robust design
- Low friction
- High-speed capability
- Accommodate radial and axial loads in both directions
- Require little maintenance

Overview

Dimensions

Bore diameter	4 mm
Outside diameter	16 mm
Width	5 mm

Performance

Basic dynamic load rating	1.11 kN
Basic static load rating	0.38 kN
Limiting speed	60 000 r/min
Reference speed	95 000 r/min

Properties

Bore type	Cylindrical
Cage	Sheet metal
Coating	Without
Filling slots	Without
Locating feature, bearing outer ring	None
Lubricant	None
Matched arrangement	No
Material, bearing	Bearing steel
Number of rows	1
Radial internal clearance	CN
Relubrication feature	Without
Sealing	Without



Technical Specification

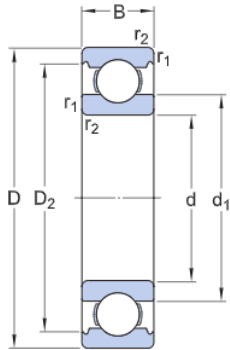

Dimensions

d	4 mm	Bore diameter
D	16 mm	Outside diameter
B	5 mm	Width
d ₁	≈ 8.4 mm	Shoulder diameter
D ₂	≈ 13.3 mm	Recess diameter
r _{1,2}	min. 0.3 mm	Chamfer dimension

Abutment dimensions

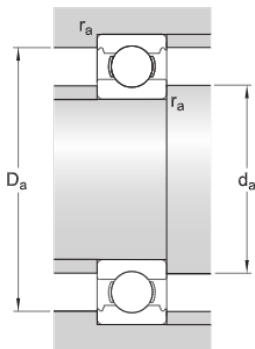

d _a	min. 6.4 mm	Diameter of shaft abutment
D _a	max. 13.6 mm	Diameter of housing abutment
r _a	max. 0.3 mm	Radius of shaft or housing fillet

Calculation data

Basic dynamic load rating	C	1.11 kN
Basic static load rating	C ₀	0.38 kN
Fatigue load limit	P _u	0.016 kN
Reference speed		95 000 r/min
Limiting speed		60 000 r/min
Minimum load factor	k _r	0.03
Calculation factor	f ₀	8.4

Mass

Mass bearing

0.0054 kg

Tolerance class

Dimensional tolerances

Normal

Radial run-out

Normal